



DRV-B-EC

## DRV-EC

### VENTILATION OF BUILDINGS, OFFICES AND PRODUCTION FACILITIES.

Energy-efficient, rotary speed-controllable and low-noise due to EC technology. Up to 50% energy savings achievable in practice

- Controlled ventilation possible (basic and needs-based ventilation)
- Optionally available with regulation (constant pressure or constant volume flow rate)
- Simple installation and maintenance-friendly
- High efficiency, even in controlled mode
- Rotary speed steplessly adjustable
- Operating point can be optimally adjusted to the system requirements
- Simple system balancing
- A system's volume flow rate and its pressure can be regulated
- Cut operating costs
- Longer service life than conventional motors
- Unit sizes
- Volume flow rate V max. 3,700 m<sup>3</sup>/h
- Total pressure increase p<sub>1</sub> max. 450 Pa

## Application



### Application

- Roof-mounted extract air fan
- Free outlet
- Free inlet or pipeline on the inlet side

## Description



### Accessories

- Volume flow rate measuring unit VME
- Steel roof base for smooth roofs
- Sound attenuating base
- Self-powered shut-off damper (optional: thermally insulated damper blade)
- Motor-powered shut-off damper
- Flexible connectors
- Matching flange
- Equipotential bonding

- Cover grille (inlet and outlet side)
- Terminal box
- Insulated base plate
- Tilting frame for foldable type
- Silicone-free type

**Life cycle assessment**

A life cycle assessment is available for the product series in form of an Environmental Product Declaration (EPD) that has been checked and published by a programme holder.

## TECHNICAL INFORMATION

### Dimensions and weight



Dimensions [mm]

①	ØD	□A	H	h	□A <sub>1</sub>	Ød	M
180	64	409	338	34	362	10	M6 x 3
250	494	557	408	40	460	14	M6 x 3
315-L	694	557	421	40	460	14	M8 x 4
315-H1	694	557	458	40	460	14	M8 x 4
315-H2	694	557	458	40	460	14	M8 x 4
355	861	706	511	40	600	14	M8 x 4
400	861	770	624	40	600	14	M8 x 6
500-L	1116	995	586	40	880	18	M8 x 6
500-H	1116	995	586	40	880	18	M8 x 6

① Nominal size

#### Base plate DRV-B-EC

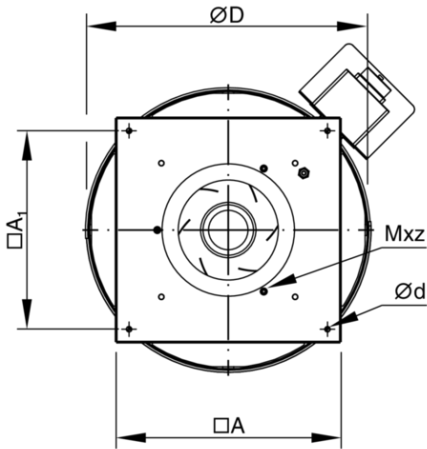

DRV-B-EC

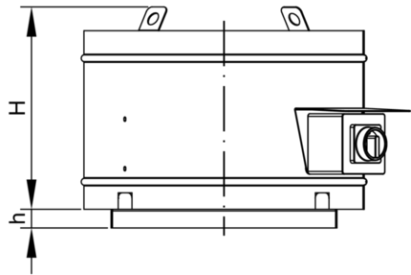

## DETAILED DESIGN



HERE YOU'LL HAVE DIRECT ACCESS TO SELECT THE DRV VIA THE TROX X-FANS PRODUCT CONFIGURATOR

Following features are at your disposal::

- Based on your requirements of volume-flow, pressure and installation arrangement including desired accessories select the ideal fan...
- Appropriate selection according to required power, sound, nominal size, price and production period
- Options and accessories get assessed for plausibility
- All required documents (e.g. technical specification, tender specification, certificates, drawings etc.) of specific selected fan to be downloaded or send by E-Mail